

LOW FLOW AIR PROCESS & LIQUID CIRCULATION HEATER For In-Line Air, Gas & Liquid Heating **IL-D1 MODEL**



The Inline heaters are used to heat low flows of air, gas, water, or aqueous solutions. Applications include those where clean air is necessary, as in laboratories and environmental testing areas. The stream of air is heated by passing over an enclosed heated surface rather than directly over resistance elements. This method assures that no foreign matter will enter the stream of flow. The Inline Heater is also used as a miniature circulation heater for small volume of liquids as in photographic developer solution, chemicals, dyes, and inks.

SPECIFICATIONS

- Cross Sectional Area:** 0.152 sq inches
- Pressure Rating :** Up to 100 PSIG
- Wattage Tolerance :** +5. -10% or better at the voltage specified
- Outside Diameter :** 32mm (1-1/4")
- Inlet :** Male 3/8"NPT
- Outlet :** 1/2"NPT

- ✓ 316 Stainless Steel Construction
- ✓ Air/Gas Flow up to 15 CFM
- ✓ Air/Gas Outlet Temperatures up to 430°C
- ✓ Pressure Up to 100 PSI
- ✓ 50 Watts / square inch

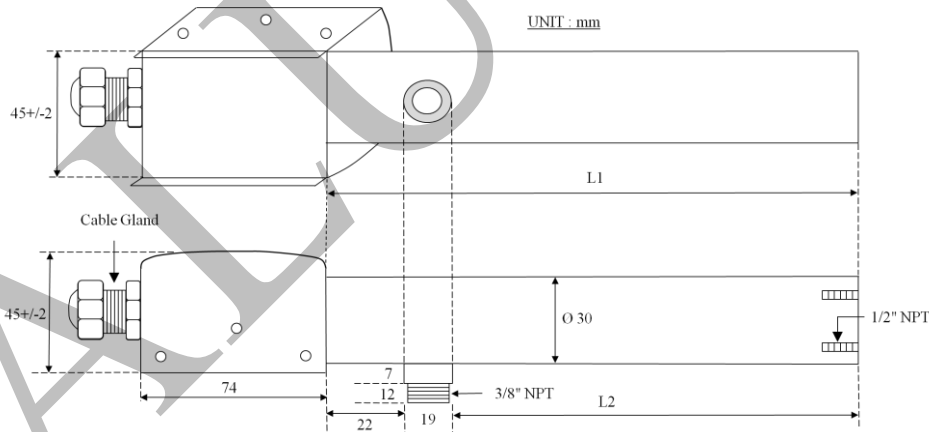

APPLICATION

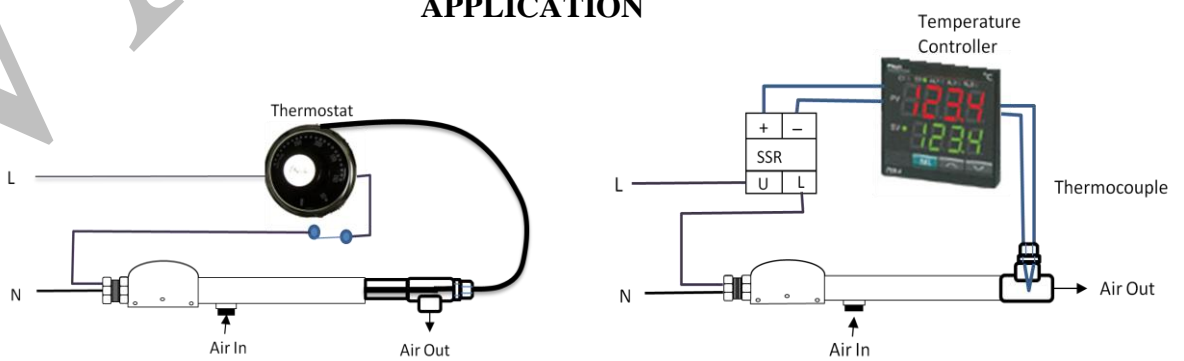

LOW FLOW AIR PROCESS & LIQUID CIRCULATION HEATER For In-Line Air, Gas & Liquid Heating **IL-D1 MODEL**

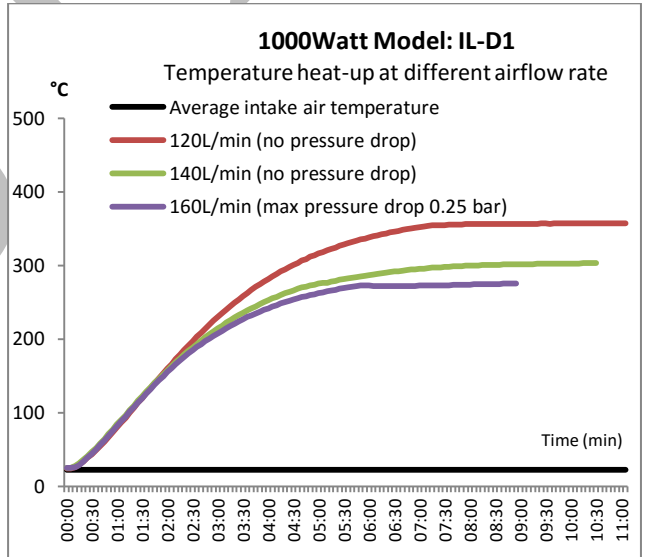
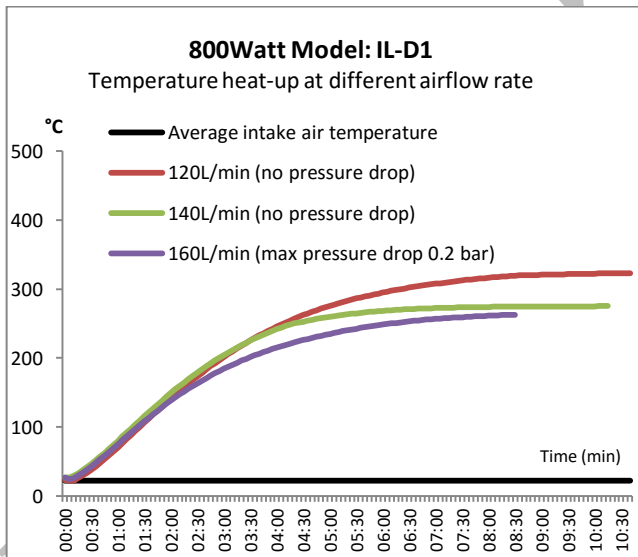
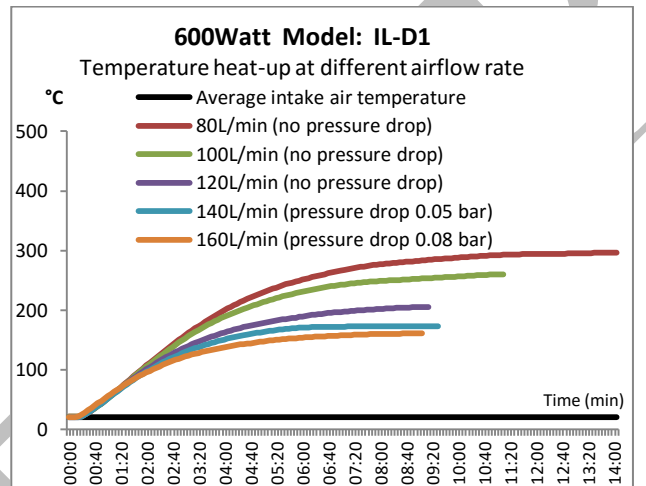
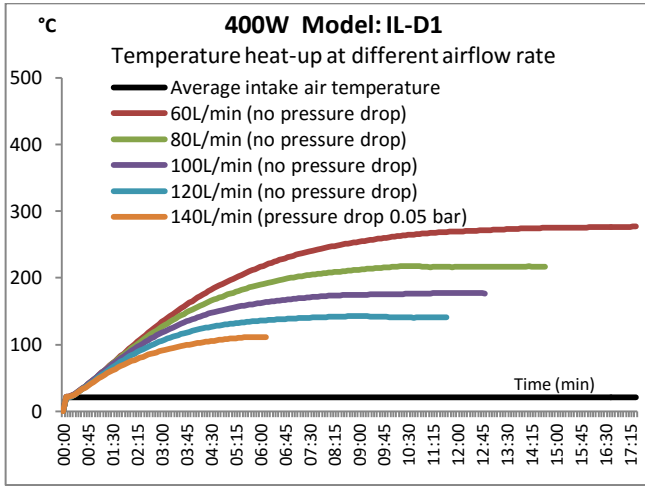

STANDARD MODEL									
Order Code	Rating	Amp (A)	L1 mm	L2 mm	Order Code	Rating	Amp (A)	L1 m	L2 mm
IL-D1-001	100V 250W	2.5	213	173+/-2	IL-D1-007	100V 800W	8	295	254+/-2
IL-D1-002	200V 250W	1.25	213	173+/-2	IL-D1-008	200V 800W	4	295	254+/-2
IL-D1-003	100V 400W	4	213	173+/-2	IL-D1-009	100V 1000W	10	295	254+/-2
IL-D1-004	200V 400W	2	213	173+/-2	IL-D1-010	200V 1000W	5	295	254+/-2
IL-D1-005	100V 600W	6	213	173+/-2					
IL-D1-006	200V 600W	3	213	173+/-2					